

DEED REFERENCE
JOSEPH BENTON HEDGES &
BARBARA ANN HEDGES ARTHURS
 OR 798 PG 349
 (A) 57.0151 ACRES
 PARCEL No. D1200010007400 &
 PARCEL No. D1300300011400

BEARINGS ARE BASED ON A
 GPS OBSERVATION ON 08/24/17
 WGS 1984 GEODETIC NORTH.

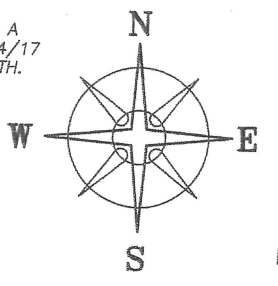

ROBERT C HESS, TRUSTEE
 OR 671 PG 1374
 PARCEL C: TRACT No 2: 64.30 ACRES

ROBERT C HESS, TRUSTEE
 OR 671 PG 1374
 PARCEL C: TRACT No 4: 75 ORIGINAL ACRES

ROBERT C HESS, TRUSTEE
 OR 671 PG 1374
 PARCEL C: TRACT No 3: 55.50 ACRES

LINE	BEARING	DISTANCE
L1	N 85°46'00" W	158.01'
L2	N 03°41'28" E	148.19'

D1200010007400
55.9126± ACRES
 (TO BE ANNEXED)
 (A)

JEFFREY CALL
 OR 790 PG 3581
 41.2770 ACRES
 D1200010007401

SURVEY PLAT AND LEGAL DESCRIPTION
 MATHEMATICALLY APPROVED
 PICKAWAY COUNTY ENGINEER
 BY: JAF DATE: 10/11/2022

JEFFREY CALL
 OR 789 PG 4897
 2.731 ACRES (AUDITOR)
 123.847 ORG ACRES
 D1200010006400

LEGEND

- ALL MONUMENTS FOUND OR SET ARE IN GOOD CONDITION UNLESS OTHERWISE NOTED.
- (A) 14" OCTA. CONC. FENCE POST (FOUND)
- (B) 1/2" Ø IRON PIPE (FOUND)
- (C) 1" Ø IRON PIPE (FOUND)
- (D) IRON PIN (FOUND)
- (E) 1" SQUARE IRON PIN (FOUND)
- (F) MAG NAIL (SET)
- (G) 5/8" Ø REBAR & RED PLASTIC CAP STAMPED "ME CLARK" (FOUND)
- (H) 5/8" Ø REBAR & YELLOW PLASTIC CAP STAMPED "COTTRILL SURVEYING" (SET)

CONTIGUITY NOTES

TOTAL PERIMETER OF AREA: 7206.23'
 TOTAL LENGTH OF CONTIGUITY: 2548.32'
 PERCENTAGE OF CONTIGUITY: 35.4%
 THE 1.1025± ACRE PORTION OF THE 58.363 ACRE TRACT HAS BEEN PREVIOUSLY ANNEXED INTO THE VILLAGE OF ASHVILLE AND NOT PART OF THE CURRENT ANNEXATION.

- EXISTING CORP LINE
- PROPOSED CORP LINE
- SECTION LINES

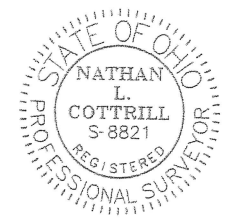

I HEREBY CERTIFY THAT THIS PLAT DEPICTS AN ACTUAL FIELD SURVEY PERFORMED BY NATHAN L. COTTRILL, P.S. #8821
 DATE: 10/11/22

COTTRILL SURVEYING, INC

James R Cottrill, PS Nathan Cottrill, PE PS
 15882 US Route 62 NE, Mt. Sterling, Ohio 43143
 Office: (740) 869-3811 www.cottrillsurveying.com

ANNEX 55.9126± ACRES,
S7,T9N,R21W, HARRISON TWP,
PICKAWAY COUNTY, STATE OF OHIO.
SURVEYED FOR GRAND COMMUNITIES

SCALE : 1" = 200'	JOB No. S220609	CREW: NC
200' 100' 0 200'	SURVEYED 11/2021	DWN BY: NC
	DRAWN 06/2022	CHECK: RC

**Annexation
 Petition
 Exhibit B**