

DESIGN DESIGNATION	
STATE ROUTE 752 & LONG STREET	
DESIGN SPEED .....	35 MPH
LEGAL SPEED .....	35 MPH
FUNCTIONAL CLASSIFICATION .....	ARTERIAL
NORTH & SOUTH BOUND LONG STREET LEFT TURN LANE LENGTH .....	150' STACKING
EAST & WEST BOUND STATE ROUTE 752 LEFT TURN LANE LENGTH .....	200' STACKING

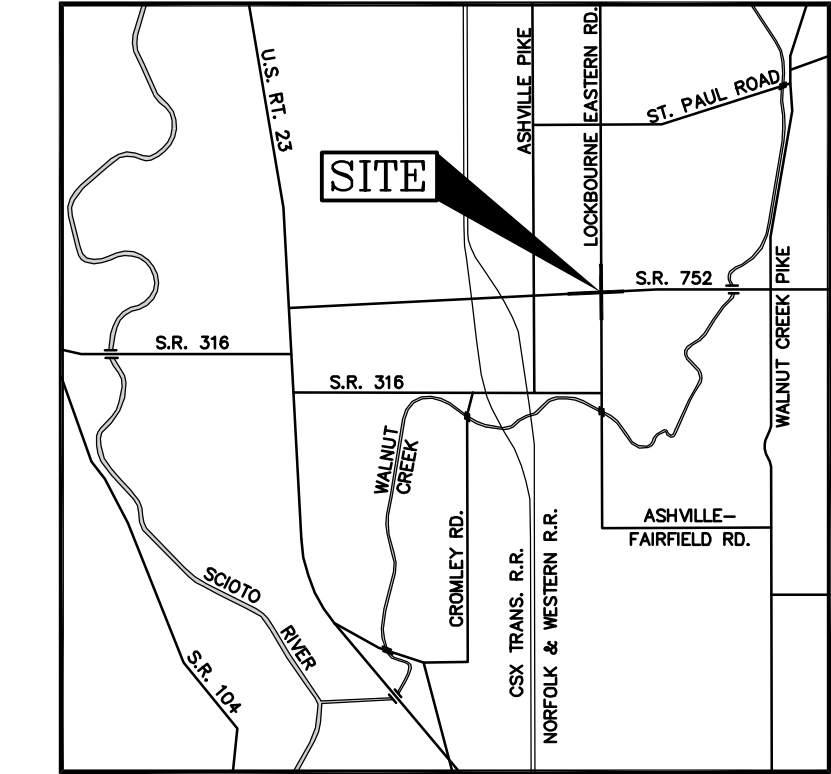
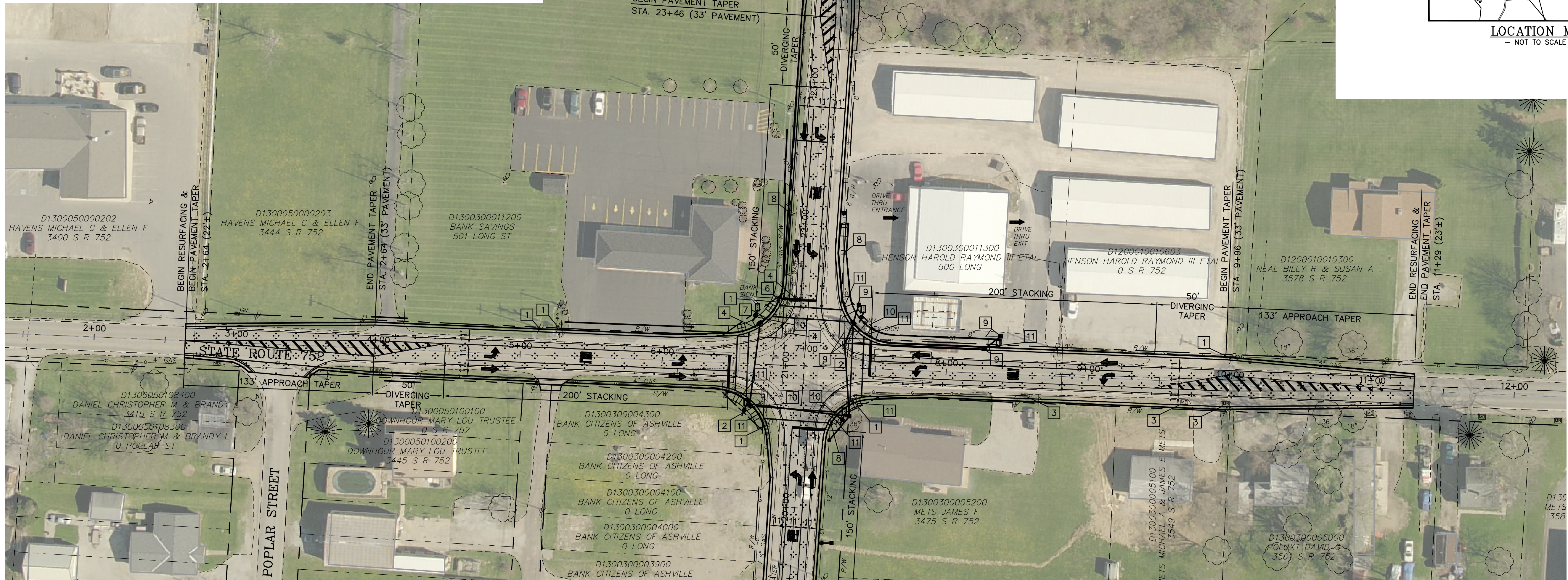

LOCATION MAP  
- NOT TO SCALE -

INDICATES LIMITS OF ASPHALT RESURFACING

**KEY NOTES**

- 1 = RELOCATE EXISTING UTILITY POLE
- 2 = RELOCATE EXISTING TRAFFIC POLE
- 3 = RELOCATE EXISTING MAILBOX
- 4 = WATER VALVE, ADJUST TO GRADE WITH HEAVY DUTY VALVE BOX
- 5 = WATER METER, ADJUST TO GRADE WITH HEAVY DUTY VALVE BOX
- 6 = WATER VALVE, ADJUST TO GRADE WITH HEAVY DUTY VALVE BOX
- 7 = RELOCATE EXISTING FIRE HYDRANT
- 8 = RELOCATE EXISTING CATCH BASIN
- 9 = PROPOSED STORM SEWER
- 10 = PROPOSED STRAIN POLE WITH PUSH BUTTON
- 11 = PROPOSED CURB RAMP

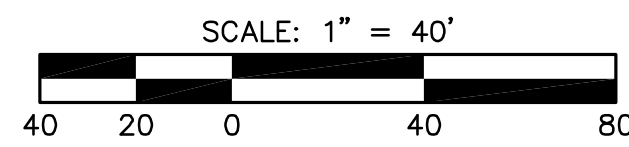

**LEGEND**

- 1 ITEM 448 - 1-1/4" ASPHALT CONCRETE SURFACE COURSE, TYPE 1, PG 64-22 (O.D.O.T.)
- 2 ITEM 448 - 1-3/4" ASPHALT CONCRETE INTERMEDIATE COURSE, TYPE 2, PG 64-22 (O.D.O.T.)
- 3 ITEM 301 - 6" BITUMINOUS AGGREGATE BASE, PG 64-22
- 4 ITEM 408 - BITUMINOUS PRIME COAT, 702.02, RC-250, MC-30, 702.03, MC-250 (APPLIED AT 0.35 GAL. PER SQ. YD.)
- 5 ITEM 304 - 6" AGGREGATE BASE
- 6 ITEM 203 - SUBGRADE COMPACTION
- 7 ITEM 609 - SPECIAL 18" CURB (STANDARD DRAWING 2000 DR. A)
- 8 ITEM 659 - SEEDING AND MULCHING
- 9 ITEM 825 - CRACK SEALING, TYPE II (O.D.O.T.)
- 10 ITEM 825 - FULL DEPTH SAWCUT
- 11 ITEM 407 - TACK COAT (0.10 GAL./S.Y.)
- 12 ITEM 605 - PIPE UNDERDRAIN

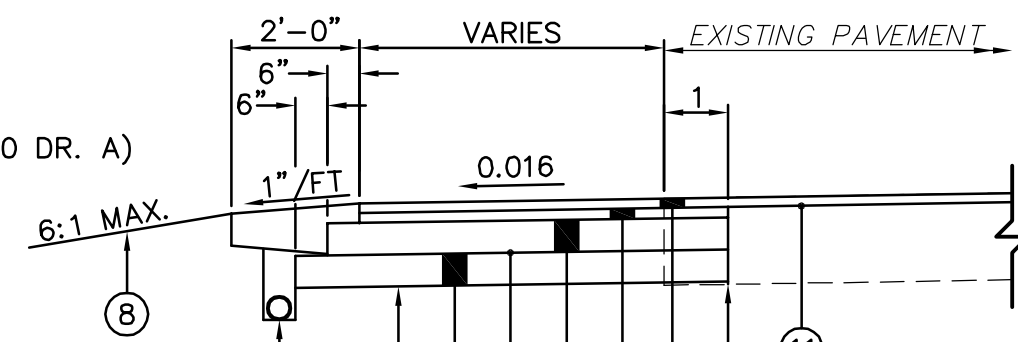

TYPICAL WIDENING SECTION  
SCALE: 1" = 3'

**Pomeroy & Associates, Inc.**  
Consulting Engineers & Surveyors  
599 Schenck Court • Worthington, Ohio 43085  
Phone (614)865-2199 • Fax (614)865-2886

PRELIMINARY DESIGN EXHIBIT  
INTERSECTION IMPROVEMENTS  
STATE ROUTE 752 AT LONG STREET  
ASHVILLE, OHIO

REVISIONS	
JOB NO.	2161
DRAWN BY	WRA
DESIGN BY	WRA
CHECKED BY	BJS

**SHEET**  
**1**  
OF **1**